

PIVOT DOOR Specs



Description

Pivot armored entrance door for large wall openings 1,2m-1,95m wide, 2m-4m high. It consists of a reinforced galvanized steel core, with rockwool insulation, and a variety of panels for both sides (aluminum, glass, wood). The frame is made of powder-coated galvanized steel and is covered with moldings in the same colour of the panels. This structure ensures that the door will not warp when exposed to extreme temperatures and along with the 8-locking point system offers high security and anti-burglar resistance.

Standard Equipment

- Adjustable heavy-duty axis hinge
- 8-point european cylinder gear lock
- Drop-down seal on top and bottom of the door
- EPDM gasket on side frames and double brushes on the doorleaf
- Convex lever of choice

Extras

- Electromechanic lock with options of keyboard or fingerprint to open the door
- Engraved handle options
- Concealed door-closer with possibility to hold the door open
- Aluminum saddle (silver)

Exterior-use panel colours

Aluminum: RAL, WOOD EFFECTS

GLASS: RAL

WOOD: Solid, Oak Plywood (HYDRO-OIL)
(wood requires regular maintenance)

Interior-use panel colours

Laquered: RAL (Matt, Gloss, Textured)

Wood: Oak veneer (SD OAK), American walnut veneer

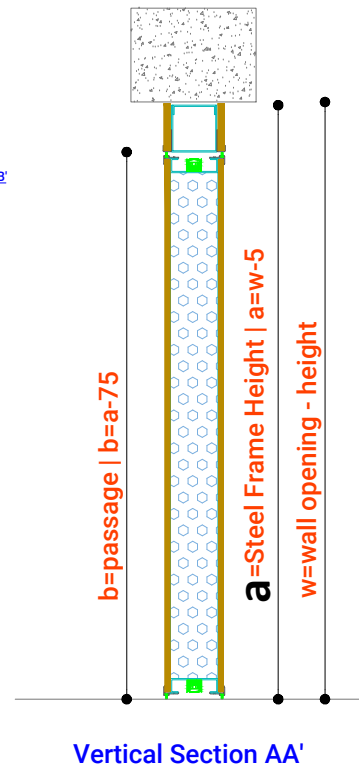
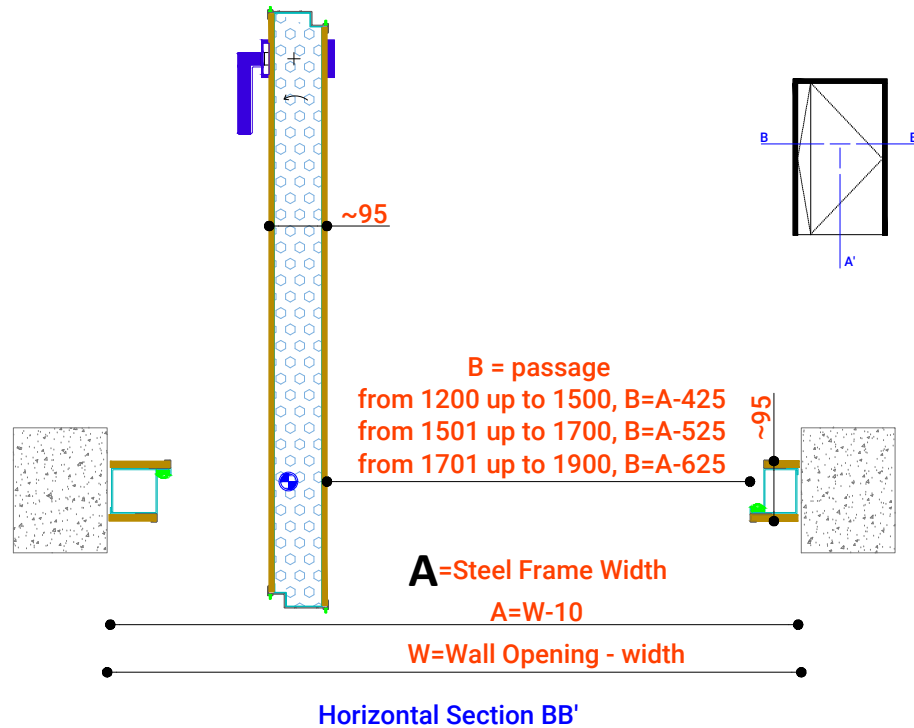
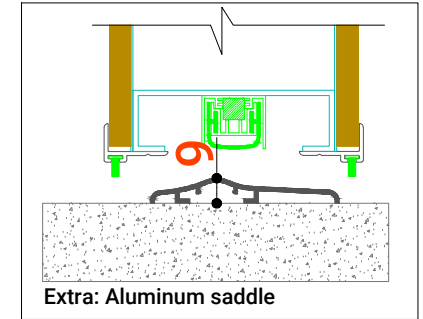

Typology

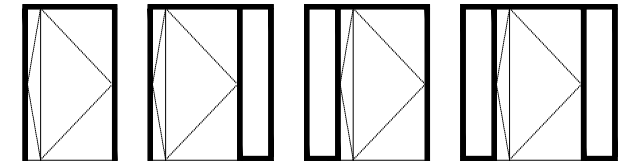

Fixings can be

- coplanar with the doorleaf (same colour as the door)
- Sidelights with a triplex-glass panel (low-iron is optional)

Note: The order is placed using the frame dimensions **A** & **a**, choosing the opening side and installation type (see document INSTALLATION TYPES)